

Universe	Professional
Type	Verticality
Category	Descenders
Subcategory	Self-braking descenders



I'D® S

The self-braking I'D S descender is primarily designed for work at height and rope access work. It has an ergonomic handle that allows comfortable descent control. The integrated anti-panic function and anti-error catch limit the risk of an accident due to user error. The AUTO-LOCK system allows users to easily position themselves at a workstation without having to manipulate the handle or tie off the device. Once locked, the rope can be taken up without having to manipulate the handle. The safety gate allows the rope to be installed with the device remaining connected to the harness. I'D S is compatible with 10 to 11.5 mm ropes and allows handling of loads up to 250 kg.



The descender has a safety gate on the moving side plate that allows the rope to be installed easily while the device remains connected to the harness.



The ergonomic handle allows unlocking the rope and comfortably controlling the descent.

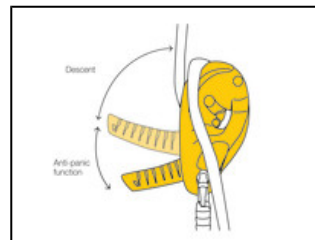

The anti-panic function automatically stops the descent if the user pulls too hard on the handle.

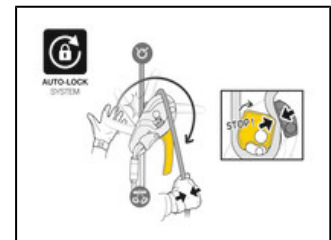



The AUTO-LOCK system allows users to easily position themselves at a workstation without having to manipulate the handle or tie off the device: as soon as the user releases the handle, the rope is automatically locked in the device.

Short Description Self-braking descender with anti-panic function for work at height and rope access work

- Selling Points**
- Designed for work at height and rope access work
 - Easy to use:
 - safety gate on the moving side plate allows the rope to be installed easily while the device remains connected to the harness
 - easy rope installation, thanks to the rope guide and markings
 - anti-error catch to reduce the risk of an accident due to incorrect installation of the device on the rope
 - ergonomic handle allows the rope to be released and enables comfortable control of the descent. Two possible descent modes: on the side plate or in the V-shaped friction channel
 - anti-panic function automatically stops the descent if the user pulls too hard on the handle
 - allows smooth movement along inclined or horizontal terrain
 - The AUTO-LOCK system allows users to easily position themselves at a workstation without having to manipulate the handle or tie off the device: as soon as the user releases the handle, the rope is automatically locked in the device. The automatic return system on the handle limits the risk of the device getting accidentally snagged
 - handle automatically switches to storage position when the rope is removed from the device, reducing the risk of accidental snagging when the descender is carried on the harness
 - Versatile:
 - once locked, the rope can be taken up without having to manipulate the handle, for making a reversible haul system or for easy short ascents, for example
 - cam can be manipulated to feed out slack easily or belay a lead climber using climbing techniques
 - the moving side plate locks with a screw, allowing the I'D S to be integrated into rescue kits
 - an auxiliary brake, open or closed, may be added to improve descent control depending on the weight and rope diameter
 - The stainless steel wear plate improves durability by reinforcing the rope friction zone
 - Descending a heavy load up to 250 kg
 - Rope compatibility: 10 to 11.5 mm diameter
 - Available in two colors: yellow and black

-
- Specification**
- Material(s): aluminum, steel, nylon
 - Weight: 600g
 - Maximum working load for one person: 150 kg (more information in the Instructions for Use and in the technical tips at www.petzl.com)
 - Maximum working load for two persons (rescue): 250 kg (more information in the Instructions for Use and in the technical tips at www.petzl.com)
 - Certification(s): EN 341 type 2 class A, CE EN 12841 type C, CE EN 15151-1, ANSI Z359.4, NFPA 1983 Technical Use, EAC
 - EN 341 type 2 class A when used with a PARALLEL 10.5 mm or AXIS 11 mm rope
 - EN 12841 type C when used with a 10 to 11.5 mm EN 1891 A rope
 - EN 15151-1 when used with a 10 to 11 mm rope
 - ANSI Z359.4 when used with a 10 to 11.5 mm rope
 - NFPA 1983 Technical Use when used with a 10 to 11.5 mm rope
-

Specifications by reference

Reference(s)	D020AA00	D020AA01
		
Color(s)	yellow	black
Rope compatibility	10 to 11.5 mm	10 to 11.5 mm
Made in	FR	FR
Guarantee	3 years	3 years
Inner Pack Count	1	1
Quantity Per Box	6	6
EAN	3342540826731	3342540826717

Related product(s)
 AXIS 11 mm
 PARALLEL 10.5 mm
 ASCENSION
 FOOTAPE
 CORDEX PLUS